



SERIES BD 6000

## Truck Brake Tester BD 6000 | 16t | 1100mm | 8-point scale | 230V

Article number: 1691810113

## Description

### **BD 6000: Robust mechanics, maximum reliability**

#### **Truck brake tester for premium demands**

- For trucks up to 16t axle load
- Completely hot-dip galvanized
- Electromagnetic motor brake
- Quartz-coated premium rollers with 1100mm length

#### **Fully equipped without compromise**

- 8-point scale for measuring axle weight and deceleration
- 2 rotation speeds
- 4x4 automatic all-wheel drive detection
- Speed sensor
- 50 mm roller elevation for more precise and safer testing
- Including ICperform software
- Including ICperform tablet app

#### **Display options: analog, digital or mobile**

- Analog: Classic visualization on an analog display
- Digital: Full control with ICperform software on your PC
- Mobile: Measurement values directly on the tablet in the driver's seat

#### **ICperform software – analog is so yesterday**

- Additional measurement variables such as axle weight, brake force difference, minimum braking, brake pressure per axle, runout, rolling resistance, etc.
- Immediate clarity: Intuitive and quick to use
- Precise control over any axle
- Print and database function
- Connect with other devices in the test lane

#### **ICperform via tablet app: Perform tests and control without leaving the vehicle**

- No constant getting in and out of the vehicle
- Measurement values directly from the driver's seat
- Convenient control of the entire test procedure

#### **Modularly expandable at any time**

- APS3 wireless pressure sensors: wireless measurement of pressure values in truck or trailer braking systems
- BPF 200 wireless pedal force meter: wireless measurement of pedal force for high repeatability
- MSS 8400 toe tester: measures axle play and straight-line stability for wheel alignment recommendations
- GST8508 and GST8600 joint play testers: quick detection of defects and wear in the wheel suspension

## Scope of delivery

- 2x roller set with weighing function
- Control cabinet
- 15 m cable set
- ICperform software
- ICperform tablet app

Minimum PC requirements: Windows 11 Professional, CPU 3GHz (Intel Pentium Gen 12), 8GB DDR5, 512GB SSD, 6x USB, 1x RS232 (for infrared remote control), 1x LAN. The additional use of a tablet requires a PC with ICperform software and a Wi-Fi network with router.

## Technical Data

Electrical connection	400 V
Length	1400 mm
Height	666 mm
Width	1151 mm
Max. wheel diameter	1200 mm
Measuring system	- DMS
Roller length	1100 mm
Roller elevation	50 mm
Roller diameter	280 mm
Min. test width	900 mm
Max. test width	2900 mm
Min. wheel diameter	450 mm
Roller axle distance	438 mm
Weight without lifting device approx.	710 kg
Motor connection cable	7 x 4 mm <sup>2</sup>
Test speed (low)	2 km/h
Test speed (high)	4 km/h
Motor revolution speed (low)	1450 U/min
Motor revolution speed (high)	2950 U/min
Roller revolution speed (low)	43 U/min
Roller revolution speed (high)	87 U/min
Motor power (low)	2 x 10 kW
Motor power (high)	2 x 12,5 kW
Max. axle load testable	16 t

## Accessories

1691810704 IR remote control Truck



1691811126      Adaptation kit for Semmler Tachocontrol BD6xxx | left



1691811250      PC cabinet Standard | empty



1693740884      Monitor holder 17 - 27"



1691811539      Retrofit set for VDO tachograph test BD 6xxx | left

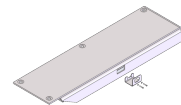

1693770658      Air pressure sensors | Truck | APS 3



1691810750      Display RAL 7016 | analog, rectangular | LCD, swivel arm, IR receiver



1693770673	ASA/APS3 wireless connection kit   Truck   433Mhz	
1691810717	Kit 4x drive-over plates   BD6xxx & BD8xxx   1000mm & 1100mm	
1691810735	Warn-System for air pressure sensors	
1691810734	Wired pedal force tester APS1   PD	
1691810702	IR Kit Truck	
1691810703	PC For Test Lanes	
1691810743	PC gear pack for PC cabinet Standard	
1691810722	Stand column aluminium   RAL 7016   for TV Monitor / rectangular analog display	

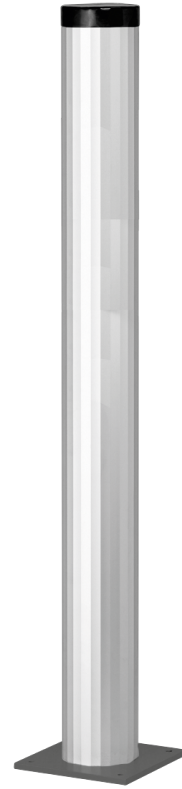

---

1691811083 Assembling case BD 6xxx / 1100 mm | without pit

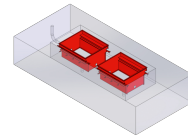

---

1691811084 Assembling case BD 6xxx / 1100 mm | with pit

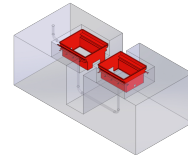

---

1691810724 Pit safety PSC2 | cross | 1,5/2,5m

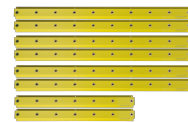

---

1691810725 Pit safety PSC2 | cross | 2,5/2,5m

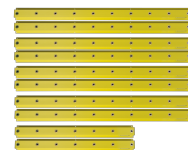

---

1693770659 Air pressure sensor Px universal | for APS3

