

TRUCK BRAKE TESTERS

**BD SERIES 5-8: 13-18 T INCLUDING LOAD SIMULATION
AND NEW SOFTWARE ICPERFORM GARAGE TRUCK**



**NEW WITH
TABLET APP!**



NEW!



Comfortably using the tablet app Beissbarth BD series 5, 6, 7 and 8



Download at play.google.com and use the app free of charge for a 30 days testing period.

You can obtain your license for the ICperform tablet app* (order number 1 691 810 756).



*Available only for Android

Beissbarth brake testers at a glance

BD 5xxx

- Up to 13 t axle load
- 2 speed, 4 x 4
- Analogue display (optional)
- Identical roller sets with MB 8815/BSA 53xx
- ICperform Garage Truck software*
- Tablet app (optional)



BD 6xxx

- Up to 16 t axle load
- 2 speed, 4 x 4
- Analogue display (optional)
- Identical roller sets with MB 8100/BSA 56xx
- ICperform Garage Truck software*
- Tablet app (optional)



BD 7xxx

- Up to 13 t axle load
- 2 speed, 4 x 4
- Fitting into any common foundation
- Analogue display (optional)
- Load simulation incl. 8-point scale (optional)
- ICperform Garage Truck software*
- Tablet app (optional)



BD 8xxx

- Up to 18 t axle load
- 2 speed, 4 x 4
- Fitting into any common foundation
- Analogue display (optional)
- Load simulation incl. 8-point scale (optional)
- ICperform Garage Truck software*
- Tablet app (optional)



*The use of the system requires a PC with ICperform Garage Truck software

BD series 5 and 6: Brake testers with proven mechanics



Beissbarth brake testers BD series 5 and 6

- Identical roller sets with brake testers
MB 8815/BSA 53xx and MB 8100/BSA 56xx
- ICperform Garage Truck software and optional tablet app
- BD 6xxx can be ordered with standard rollers (1 000 mm)
or extended rollers of 1 100 mm length (comparable with
MB 8100/BSA 56xx)



Weather-resistant hot-dip galvanization, steel chains



Speed sensor



Coated rollers



Drive-over plates

BD Series 7 and 8: Brake testers with hydraulic load simulation

In line with § 29 StVZO (VkBl. 09/2011) of the German road traffic registration ordinance ISO 21069-1; ISO 21069-2

- Lifting device for load simulation (lifting height: 200 mm)
- Neatly integrated into the roller housing
- Increases the brake-cylinder pressure to the 1.7 bar demanded
- Remote control (optional) right from the driver cab
- Suitable for almost all trucks and trailers
- Especially recommended for empty/lightweight lorries

*as of 2020 only with brake testers complying with the guideline

According to the guideline, commercial vehicles need to be tested with a minimum statutory brake pressure of 1.7 bar. In case of commercial vehicles with a high load/ no-load ratio – e.g. empty trucks and trailers – not building up the required minimum pressure, load simulation can be used as well. Instead of sophisticated tying down of multiple axles, the axle to be tested can also be lifted for the test. At this much simpler procedure, the required axial pressure is created by altering the weight balance.



Lowered roller set



Lifted roller set



Control cabinet for hydraulic load simulation



Remote control for hydraulic load simulation (optional)



Fits into any common foundation

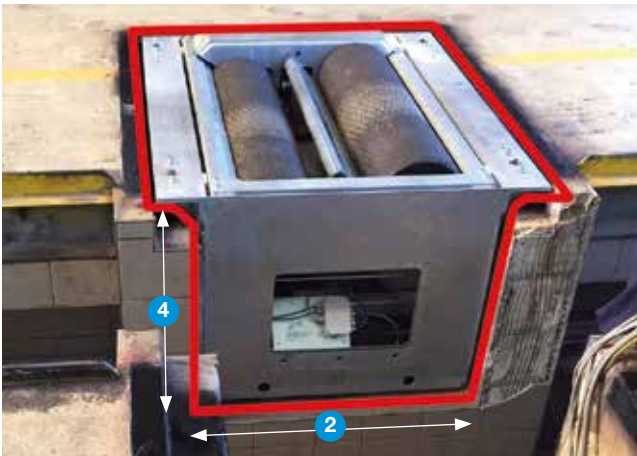

New roller set with hydraulic load simulation placed into an existing foundation – saves installation works.

Prerequisite to the foundation

Pos.	BD 7xxx (13 t)	BD 8xxx (18 t)
1	C20/25 (DIN EN 19992-1-1)	C20/25 (DIN EN 19992-1-1)
2	820 mm	920 mm
3	575 mm	675 mm
4	650 mm	750 mm
5	120 mm	120 mm
6	80 mm	80 mm
7	93 mm	93 mm
8	80 mm	80 mm

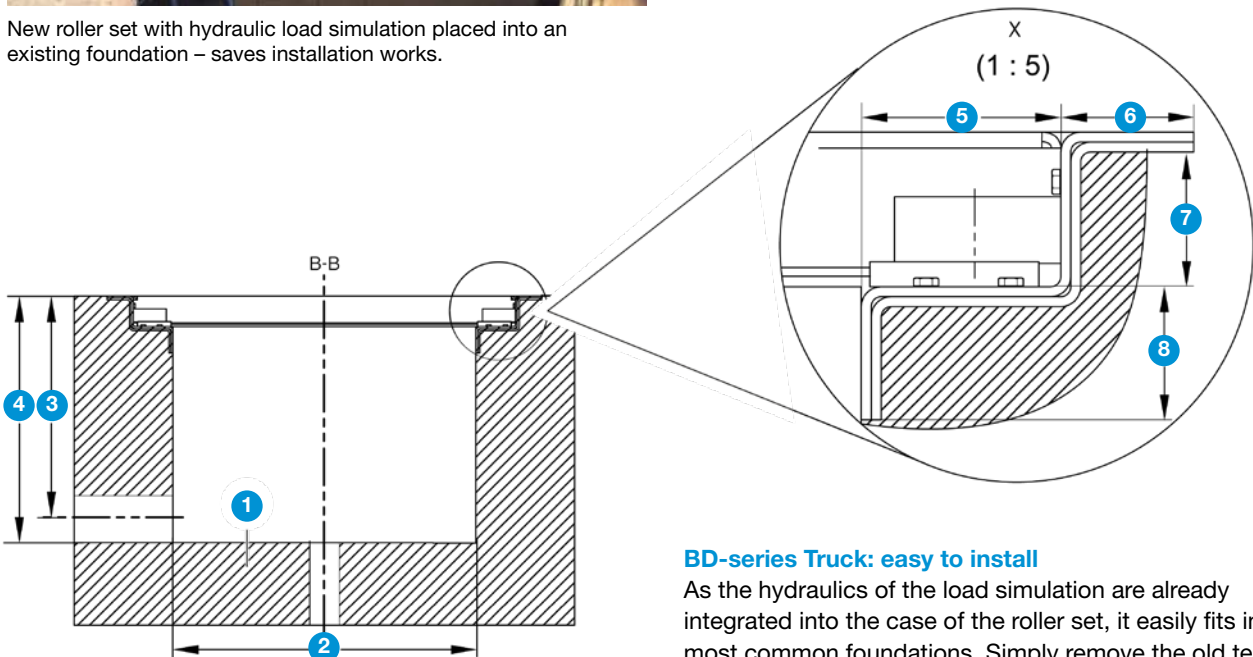

BD-series Truck: easy to install

As the hydraulics of the load simulation are already integrated into the case of the roller set, it easily fits into most common foundations. Simply remove the old tester and install the new one.

ICperform Garage Truck with new tablet app

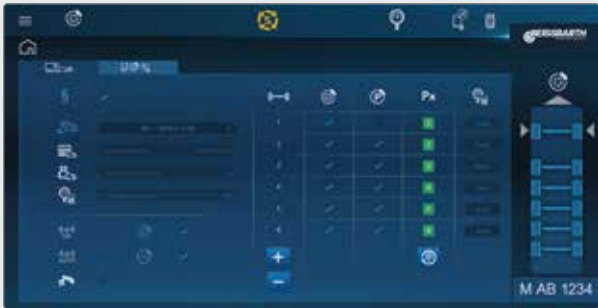

Configuration of axles and air-pressure sensor

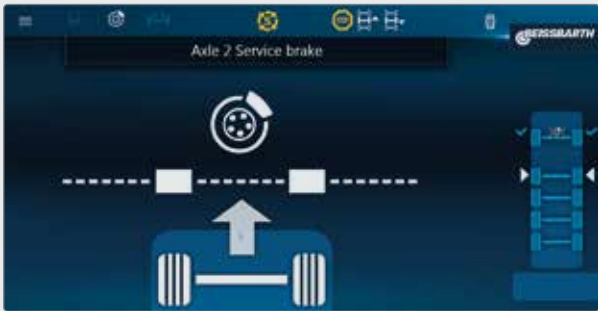

Controlled drive-in



Text message
Displays actions and results

Left clock gauge
Left brake force in kilonewton

Action indicator
here: super automatic

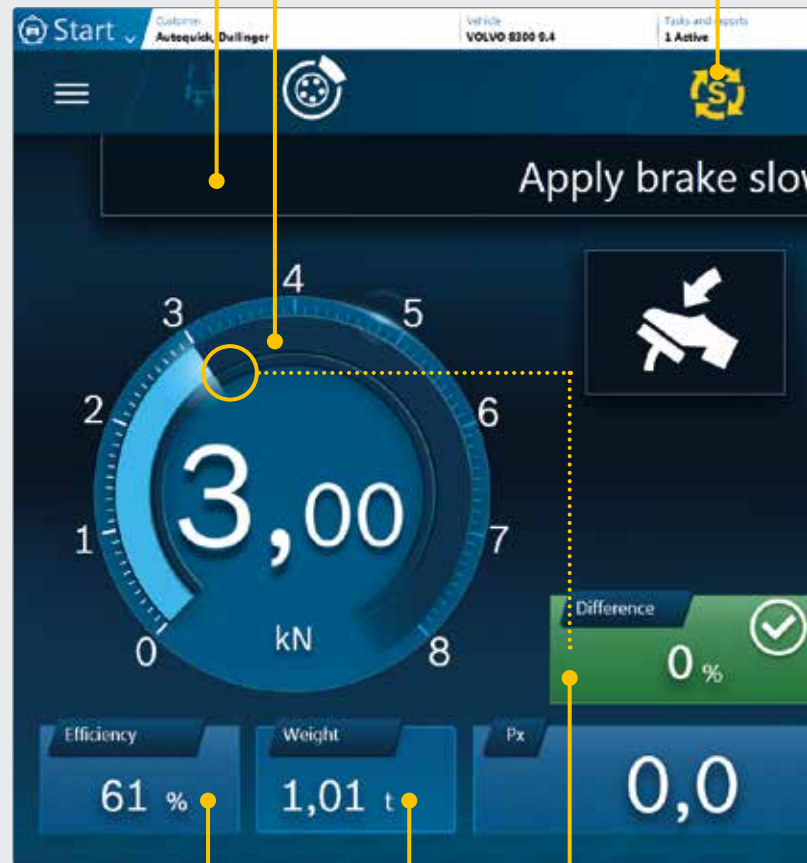

Axis braking
Calculated value from axle braking force and axle weight in percent

Axle load
in tons

Brake-force difference indicator
Difference between left and right brake force in percent. Within the tolerance range displayed in green, outside in red.

ICperform Garage Truck software: Up to 6 axles in one measurement

- Optimum display of all relevant measured values
- Easy handling
- Faster brake testing
- Print and database functions
- Connection with other test devices within the test lane



Ovality measurement



Overview of results

Up to 6 axles

Px
Measured axial pressure

Px No.
Number of pressure sensor in remote-control version

PM
Pressure applied onto the brake pedal

Licence plate
of vehicle

All measuring results at a glance

Simply use your own flatscreen or TV monitor (HDMI)





**NEW WITH
TABLET APP**



ICperform Garage Truck: comfortably using the tablet app

ICperform Garage Truck tablet app: measuring faster without having to get on and off the truck

- The intuitive user interface can be accessed via Android tablets operate and enable stable measured value transmission and control via the WLAN connection – even from inside the vehicle.
- Roll resistance, ovality, braking forces per axis or wheel, left-right comparison or pressure values, all data are displayed in real time and visually intuitive
- Working with Beissbarth's ICperform tablet app speeds up the process and eliminates unnecessary entry and exit from the vehicle.

ICperform Garage Truck tablet app from Google Play

The app is available at play.google.com. Download it to your tablet and try the features for up to 30 days free of charge. You can obtain your license for the ICperform Garage Truck tablet app (order number 1 691 810 756) directly from the Beissbarth hotline.



Carrying out brake tests easily and quickly with the software ICperform Garage Truck tablet

- Data entry of vehicle information
- Selection of testing mode
- Test control conveniently in the vehicle cabin
- Usage of own tablet devices
- Same representation as on the workshop PC monitor

Easy control from the inside of the truck

- Intuitive and guided: fully automated procedure (covers 80 % of the common testing routines)
- Integrated remote control
- State of the braking test and important measuring results always at a glance

Min. tablet requirements

- Operating system: Android 5.0 or higher
- Minimum size: 8"
- Recommended size: 9,6"
- Width-to-height ratio: 16:9 or 16:10
- Basic requirement: WLAN network with router

Order manager and connectivity for truck workshops

Bosch Connected Repair

Bosch Connected Repair is able to read commercially available job data. Thanks to crosslinking, the central server-based software solution eases and accelerates the work processes of all connected test devices. Purchasing BD, the software for one work station is included within the scope of delivery:

- **Brake testing**
 - **Headlight testing**
 - **Emission analysis**
 - **Air condition service**
-
- Single PC installation for free
 - Additional working stations per licence (Ask your dealer for availability)
 - 16 languages

Bosch Connected Repair: for faster work processes MLD 815 headlight testers

- Tests all types of light sources (xenon, bi-xenon, LED, bi-LED, halogen) and all types of truck headlights.
- MLD 815 Matrix/DLA version for glare-free high-beam systems (DLA*, Matrix)
- With CMOS camera and integrated printer.

*Dynamic Light Assist



MLD 815 used on a truck



Accurate display of the test results on the workshop computer.

Digital headlight tester MLD 815

Accessories

Real-time display, power box, cabinet

Practical control center for the workshop



- Control cabinet for power electrics
- PC ready: direct connection to the workshop computer
- In line with § 29 StVZO (VkBf. 09/2011) of the German road traffic registration equipped with ASA livestream

Analogue display for measured values (optional)

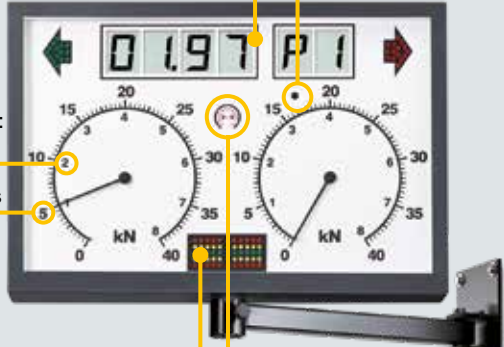

LCD displays displaying the measured values and information texts

Receiver sensor for entries via remote control

Mode shown via arrows and LCD

Large indicator of brake force scales:
0-8 kN for cars
0-40 kN for trucks

LED for evaluation of brake tests

Indicator of status of brake force scales for car or truck



Flexible concept for Beissbarth PC cabinet



Accessories	Configuration
	<p>Practical Beissbarth standard PC cabinet (basic version w/o any equipment)*</p> <p>Order number: 1 691 811 250</p>
	<p>Monitor holder to fit standard PC cabinet (up to 27")</p> <p>Order numbers: 1 691 811 250 1 693 740 884</p>
	<p>Standard PC cabinet with full PC equipment (incl. monitor holder)</p> <p>Order numbers: 1 691 811 250 1 691 810 743</p>

*System requirements for PC see page 21.



Safe working in the pit

PSC1, pit safety protection, alongside



PSC2, pit drive-in protection, transverse, 3 different sizes, see accessories, page 20

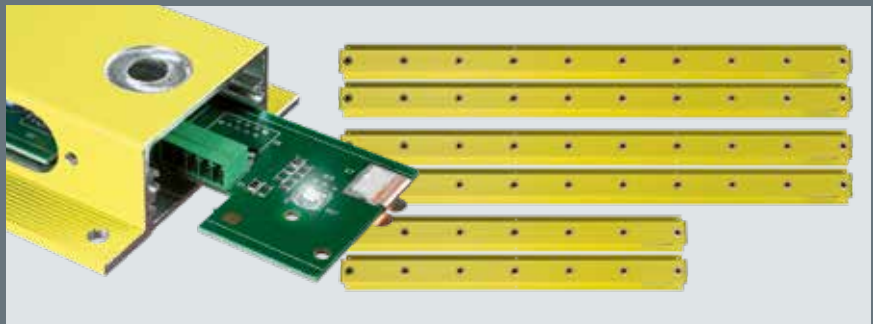

Robust and durable by hot-dip galvanization



Durable sliding rails



8-point load cell



Option prepared for tachometer control



Drive-over plates



Strong mechanics: weather-resistant hot-dip galvanization, steel chains



Radio controlled air-pressure sensors



Installation variants

Without pit

With pit

BD 5xxx

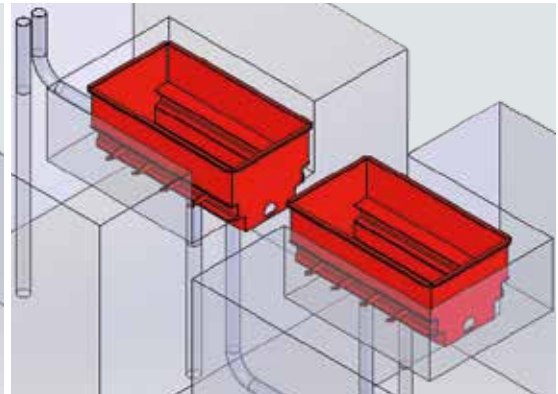
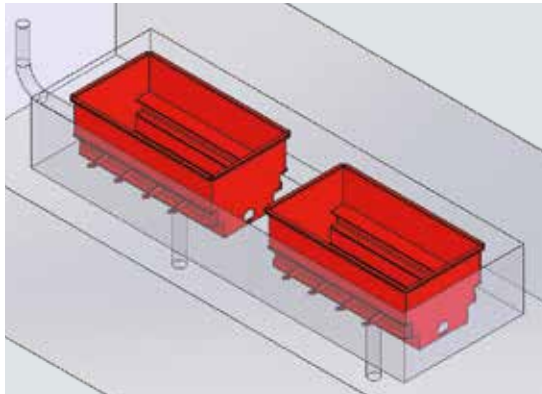

BD 6xxx

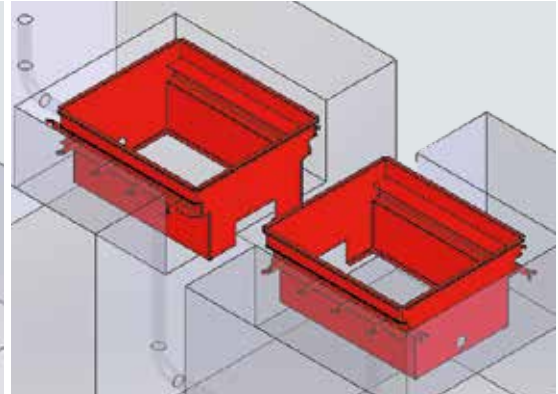
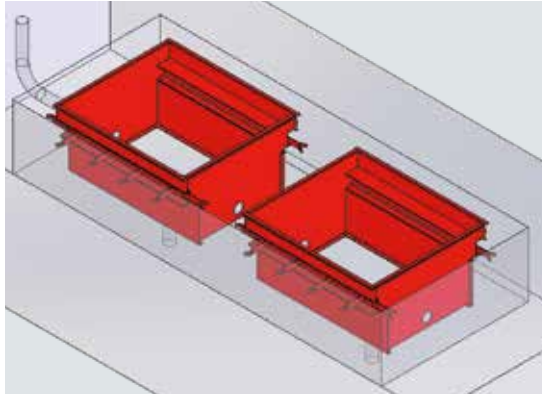

BD 7xxx

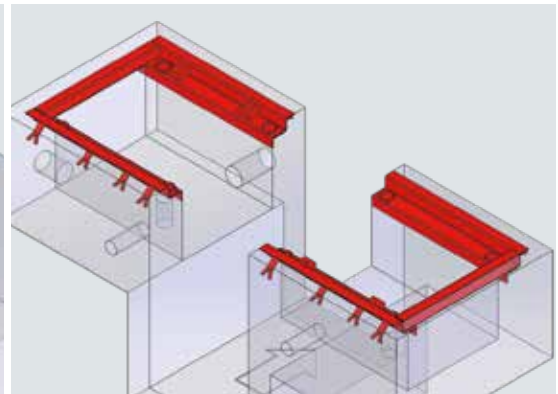
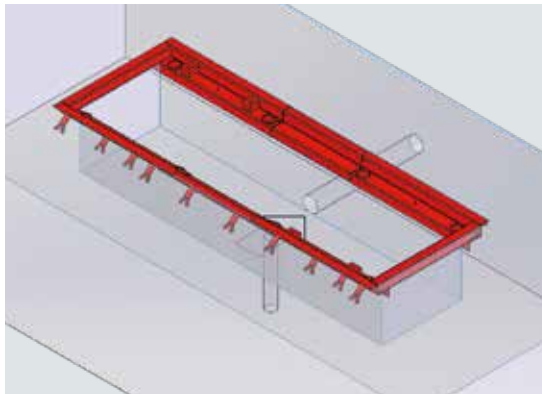

BD 8xxx

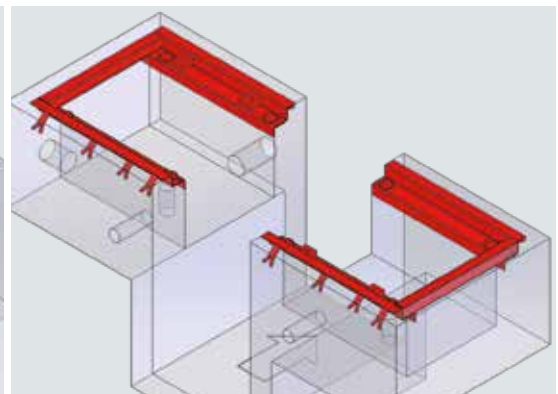
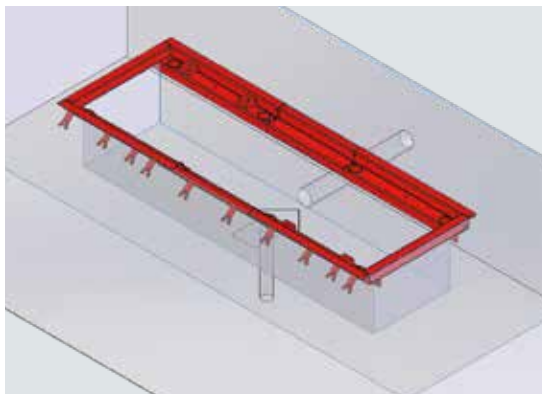

Foundation requirements

Dimensions

Brake tester

BD 5xxx

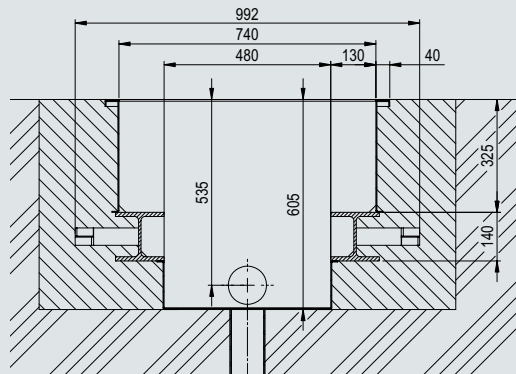

BD 6xxx

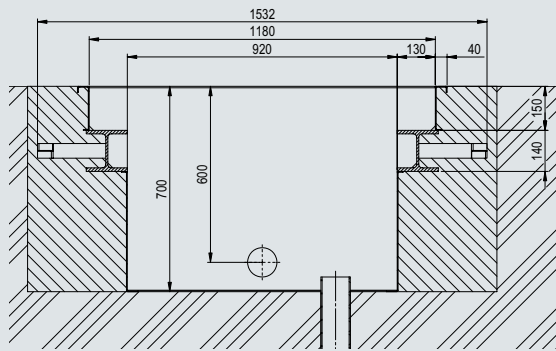

BD 7xxx

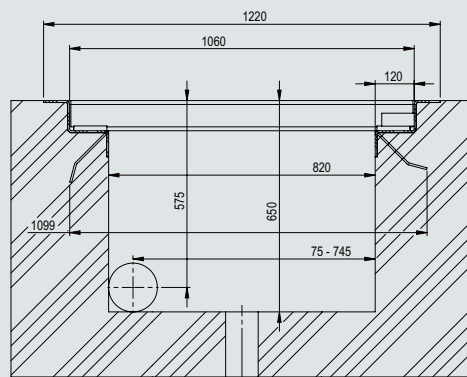

BD 8xxx

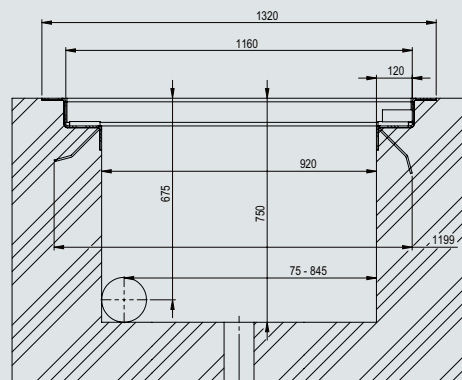

Accessories

for BD series 5, 6, 7 and 8

Figure	Mandatory accessories	Order number	5	6	7	8
	ICperform Garage Truck software (License activation required)	1 691 810 741	•	•	•	•

Figure	Optional accessories	Order number	5	6	7	8
	ICperform Garage Truck Tablet App (System requirements see page 21)	1 691 810 756	•	•	•	•
	IR remote control (incl. battery) Alternatively the control can be executed via tablet app.	1 691 810 704	•	•	•	•
	Receiver for the remote control Prerequisite: serial PC interface (COM)	977 251 428	•	•	•	•
	IR-Kit Truck (Receiver RS232, remote control, battery) With Beissbarth PC trolley and analogue display included in scope of delivery. Order optional, if own PC is used or no display is needed.	1 691 810 702	•	•	•	•
	Remote control for hydraulic load simulation	1 691 810 701			•	•
	Testlane PC (technical requirements in case of usage of own PC, see page 21)	1 691 810 703	•	•	•	•
	Standard PC cabinet	1691 811 250	•	•	•	•
	Full PC equipment (incl. monitor holder) for standard PC cabinet	1 691 810 743	•	•	•	•

Figure	Optional accessories	Order number	5	6	7	8
	Holder for a 17–27" monitor 22–35" monitor	1 693 740 884 1 693 740 911	•	•	•	•
	Analogue display, RAL 7016, LCD, swivel arm, IR receiver	1 691 810 750	•	•	•	•
	Stand column aluminum for analogue display	1 691 810 722	•	•	•	•

Figure	Installation accessories	Order number	5	6	7	8
	Assembling case BD 5xxx, with/without pit	1 691 881 204	•			
	Assembling case BD 6xxx 1 000 mm, w/o pit	1 691 811 081		•		
	Assembling case BD 6xxx 1 000 mm, for pit use	1 691 811 082		•		
	Assembling case BD 6xxx 1 100 mm, w/o pit	1 691 811 083		•		
	Assembling case BD 6xxx 1 100 mm, for pit use	1 691 811 084		•		
	Built-in frame, BD 7xxx with 1 000 mm rollers, for pit use	1 691 880 700			•	
	Built-in frame, BD 7xxx with 1 000 mm rollers, non-separated (w/o pit) , track width 2 700mm	1 691 880 701			•	
	Built-in frame, BD 7xxx with 1 000 mm rollers, non-separated (w/o pit) , track width 2 800mm	1 691 880 702			•	
	Built-in frame, BD 7xxx with 1 000 mm rollers, non-separated (w/o pit) , track width 2 900mm	1 691 880 703			•	

Figure	Installation accessories	Order number	5	6	7	8
	Built-in frame, BD 8xxx with 1 000 mm rollers, for pit use	1 691 810 713				•
	Built-in frame, BD 8xxx with 1 100 mm rollers, for pit use	1 691 810 762				•
	Built-in frame, BD 8xxx with 1 000 or 1 100 mm rollers, non- separated (w/o pit) , track width 3 000 mm	1 691 810 714				•
	Built-in frame, BD 8xxx with 1 000 or 1 100 mm rollers, non- separated (w/o pit) , track width 3 100 mm	1 691 810 715				•
	Built-in frame, BD 8xxx with 1 000 or 1 100 mm rollers, non- separated (w/o pit) , track width 3 200 mm	1 691 810 716				•
	Built-in frame, BD 8xxx with 1 300 mm rollers for pit use	1 691 810 763				•
	Built-in frame, BD 8xxx with 1 300 mm rollers, non-separated (w/o pit) , track width 3 200 mm	1 691 810 766				•
	Built-in frame, BD 8xxx with 1 300 mm rollers, non-separated (w/o pit) , track width 3 400 mm	1 691 810 764				•
	Built-in frame, BD 8xxx with 1 300 mm rollers, non-separated (w/o pit) , track width 3 600 mm	1 691 810 765				•

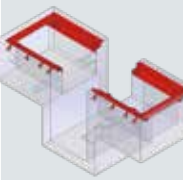
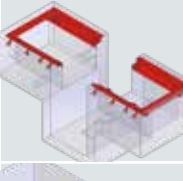
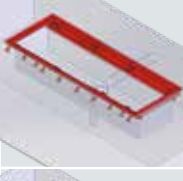
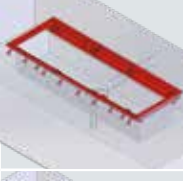
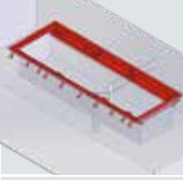
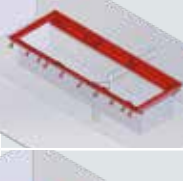
Accessories

for BD series 5, 6, 7 and 8





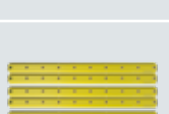

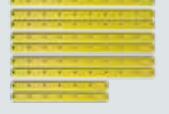
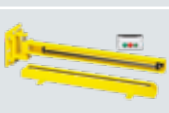



Figure	Accessories	Order number	5	6	7	8
	Kit of drive-over plates (4 pieces, 2 on each side) for BD 7xxx	1 691 880 704			•	
	Kit of drive-over plates (4 pieces, 2 on each side) for BD 6xxx and BD 8xxx with 1 000 and 1 100 mm roller length	1 691 810 717		•		•
	Kit of drive-over plates (4 pieces, 2 on each side) for BD 844x with 1 300 mm roller length	1 691 810 740				•
	PSC2, pit safety cross, 2.6 m safety area behind roller sets	1 691 810 723	•	•	•	•
	PSC2, pit safety cross, 1.5 m safety area in front of the roller sets and 2.6 m safety area behind roller sets	1 691 810 724	•	•	•	•
	PSC2, pit safety cross, 2.6 m safety area in front of the roller sets and behind roller sets	1 691 810 725	•	•	•	•
	PSC1, pit safety barrier, 15 m safety area	1 691 810 726	•	•	•	•
	PSC1, additional swivel bracket for pit protection	1 692 100 102	•	•	•	•
	Side slip tester MSS 8400	1 691 841 007	•	•	•	•
	Assembling case for MSS 8400	1 691 842 001	•	•	•	•
	Play detector GST 8508	1 691 850 100	•	•	•	•
	Assembling case for GST 8508	1 691 851 101	•	•	•	•

Figure	Accessories	Order number	5	6	7	8
	8-point scale for BD 5xxx	1 691 881 001	•			
	8-point scale for BD 6xxx	1 691 801 012		•		
	8-point scale (Depending on the configuration might be part of the scope of delivery)	1 691 810 718			•	•
	APS1, basic set of wired air-pressure sensors, PM, PX1	1 691 810 733	•	•	•	•
	APS1, wired pedal- force tester PD	1 691 810 734	•	•	•	•
	APS2, wireless pedal-force tester PD	1 691 810 731	•	•	•	•
	APS2, basic set of wireless air-pressure sensors, PM, PX1, PX2, charge unit	1 691 810 730	•	•	•	•
	APS2, additional pressure sensor PX incl. charge unit	1 691 810 732	•	•	•	•
	Warning system for the use of compressed air sensors (radio warning system with horn/ immobilizer)	1 691 810 735	•	•	•	•

Figure	Accessories	Order number	5	6	7	8
	Retrofit Set for VDO Left or right (BD 5xxx)	1 691 881 170	•			
	Retrofit Set for Semmler Left or right (BD 5xxx)	1 691 881 171	•			
	Retrofit Set for VDO Left (BD 6xxx)	1 691 811 539		•		
	Adaptation kit left for Semmler tachoccontrol: • Fixing light barrier • Roller support for Semmler rollers (BD 6xxx)	935 811 042		•		
	Adaptation kit for VDO tachograph test: • Fixing light barrier • Proximity switch (BD 7xxx)	1 691 880 705			•	
	Adaptation kit for Semmler tachoccontrol: • Fixing light barrier • Roller support for Semmler rollers (BD 7xxx)	1 691 880 706			•	
	Adaptation kit for VDO tachograph test: • Fixing light barrier • Proximity switch (BD 8xxx)	1 691 810 736				•
	Adaptation kit for Semmler tachoccontrol: • Fixing light barrier • Roller support for Semmler rollers (BD 8xxx)	1 691 810 737				•

System requirements

Min. PC requirements

- Operating system: Windows 7, Windows 10, 64 Bit
- Processor: Celeron 2.7 GHz
- Random access memory: 4 GB
- Hard disk: 500 GB
- Serial port: 2 x RS232 (COM)

Min. PC display requirements (trolley)

- Size: 27"
- Solution: 1920 x 1080
- Width-to-height ratio: 16:9

Min. HDMI-TV requirements (substitute for analogue display)

- Minimum size: 40"
- Recommended size: 55"
- Solution: 1920 x 1080
- Width-to-height ratio: 16:9

Min. tablet requirements

- Operating system: Android 5.0 or higher
- Minimum size: 8"
- Recommended size: 9,6"
- Width-to-height ratio: 16:9 or 16:10
- Basic requirement: WLAN network with router



Workshop 5

Technical specifications

Technical specifications of roller sets

Description	BD 5xxx	BD 6xxx	BD 7xxx	BD 8xxx	BD 8xxx S05
Measuring system	DMS	DMS	DMS	DMS	DMS
Dimensions (L x W x H)	1 325 x 680 x 590 mm	1 300 x 1151 x 666 mm	1 300 x 1 040 x 680 mm	1 350 x 1 140 x 782 mm	1 350 x 1 140 x 782 mm
Weight without lifting device approx.	450 kg	710 kg	450 kg	750 kg	750 kg
Weight with lifting device approx.	N/A	N/A	700 kg	1 030 kg	1 030 kg
Coefficient of friction (dry)	0.8	0.8	0.8	0.8	0.8
Coefficient of Friction (wet)	0.7	0.7	0.7	0.7	0.7
Roller length	1 000 mm	1 000 mm	1 000 mm	1 000 mm	1 000 mm
Roller diameter	205 mm	280 mm	205 mm	280 mm	280 mm
Minimum track	900 mm	900 mm	900 mm	900 mm	900 mm
Maximum track	2 900 mm	2 900 mm	2 900 mm	2 900 mm	2 900 mm
Roller axle distance	400 mm	438 mm	398 mm	438 mm	438 mm
Height difference of rear roller to front roller	35 mm	50 mm	32 mm	50 mm	50 mm
Height difference roller edge to workshop floor	0 mm	0 mm	0 mm	0 mm	0 mm
Minimum wheel diameter	450 mm	450 mm	320 mm	320 mm	320 mm
Maximum wheel diameter	1 640 mm	1 200 mm	1 000 mm	1 200 mm	1 200 mm
Protection (according to DIN 40 050)	IP 54	IP 54	IP 54	IP 54	IP 54
Roller set lifting	-	-	200 mm	200 mm	200 mm

Technical specifications of electrical motors

Description	BD 5xxx/BD 7xxx		BD 6xxx/BD 8xxx	
	Low revolution speed	High revolution speed	Low revolution speed	High revolution speed
Power supply	Via power box	Via power box	Via power box	Via power box
Principle of operation	Dahlander tapped winding: Change of speed in the ratio 1:2	Dahlander tapped winding: Change of speed in the ratio 1:2	Dahlander tapped winding: Change of speed in the ratio 1:2	Dahlander tapped winding: Change of speed in the ratio 1:2
Motor power	2 x 6.5 kW	2 x 8.5 kW	2 x 10 kW	2 x 12.5 kW
Test speed	2.2 km/h	4.4 km/h	2.3 km/h	4.6 km/h
Voltage	400 V	400 V	400 V	400 V
Gear ratio	1/16.17	1/16.17	1/17.27	1/17.27
Motor revolution speed	1 435 1/min	2 915 1/min	1 450 1/min	2 950 1/min
Roller revolution speed	57.6 1/min	117.6 1/min	43.4 1/min	87.6 1/min
Motor connection cable	7 x 4 mm ²	7 x 4 mm ²	7 x 4 mm ²	7 x 4 mm ²

Technical specifications of electrical motor BD 8xxx S05

Description	BD 8xxx S05	
	Low revolution speed	High revolution speed
Power supply	Via power box	Via power box
Principle of operation	Dahlander tapped winding: Change of speed in the ratio 1:2	Dahlander tapped winding: Change of speed in the ratio 1:2
Motor power	2 x 11 kW	2 x 13.5 kW
Test speed	2.66 km/h	5.29 km/h
Voltage	400 V	400 V
Gear ratio	1 / 17.95	1 / 17.95
Motor revolution speed	1 450 1/min	2 950 1/min
Roller revolution speed	50 1/min	100 1/min
Motor connection cable	7 x 4 mm ²	7 x 4 mm ²

Workshop 5



Configuration via internet

www.equipment-configurator.com

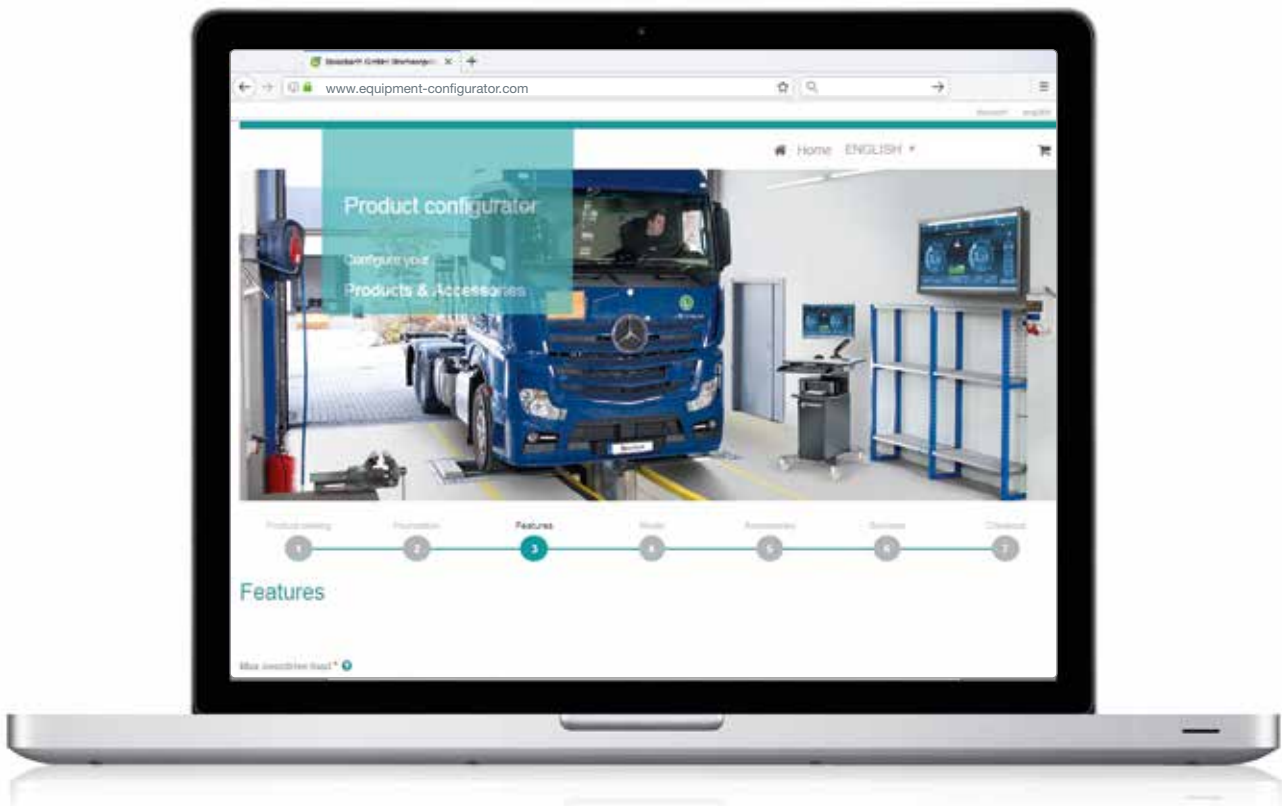

Easy and fast online product configuration

Quick and save configuration of the right brake tester

- Choose comfortably the brake tester, the control devices and the best functional accessories
- Save time by entering a structured product range, offering only combinations of compatible brake testers and accessories
- Choose brake tester, functions and accessories fitting to your workshop

Do you still have any question about the product range or the configuration process? Please don't hesitate, to ask your Beissbarth sales partner.

sales@beissbarth.com

www.equipment-configurator.com

Configurator: BD series 5, 6, 7 and 8

BD	x	x	x	x
BD	5			
BD	6			
BD	7			
BD	8			
BD		4		
BD			2	
BD			4	
BD			6	
BD				0
BD				1
BD				4
BD				5
BD				6
BD				7

S	x	x

13 t (PC ready, standard Beissbarth mechanics)
16 t (PC ready, standard Beissbarth mechanics)
13 t (PC ready, mechanics NEW 2017)
18 t (PC ready, mechanics NEW 2017)
2 speed, 4x4, rollers with granular coating
1 000 mm rollers, WITH electromagnetic motor brake
1 300 mm rollers, WITH electromagnetic motor brake
1 100 mm rollers, WITH electromagnetic motor brake
Standard
ASA livestream
Hydraulic load simulation, 8-point-scale
8-point-scale
ASA livestream, 8-point-scale
ASA livestream, hydraulic load simulation, 8-point-scale

Special versions (Sxx)

BD				
BD				
BD				
BD				
BD				
BD				

S	0	
S	1	
S	2	
S		0
S		4
S		5

(neutral)
230 V
Spike rollers
(neutral)
400 V/60 Hz
Testing speed 5.2 km/h

German scope of delivery (incl. ASA livestream) with 1 000 mm rollers*

BD	5	4	2	6
BD	6	4	2	1
BD	6	4	2	6
BD	7	4	2	1
BD	7	4	2	6
BD	7	4	2	7
BD	8	4	2	1
BD	8	4	2	6
BD	8	4	2	7

Roller set left	Roller set right	Power box
1 691 880 347	1 691 880 348	1 691 880 372
1 691 810 233	1 691 810 234	1 691 810 266
1 691 810 241	1 691 810 242	1 691 810 266
1 691 880 508	1 691 880 509	1 691 880 372
1 691 880 520	1 691 880 521	1 691 880 372
1 691 880 518	1 691 880 519	1 691 880 541
1 691 810 510	1 691 810 511	1 691 810 266
1 691 810 524	1 691 810 525	1 691 810 266
1 691 810 512	1 691 810 513	1 691 810 547

International scope of delivery with 1 000 mm rollers*

BD	5	4	2	5
BD	6	4	2	0
BD	6	4	2	0
BD	6	4	2	0
BD	6	4	2	5
BD	6	4	2	5

S	1	0
S	2	0
S	0	4

Roller set left	Roller set right	Power box
1 691 880 347	1 691 880 348	1 691 880 535
1 691 810 233	1 691 810 234	1 691 810 541
1 691 810 267	1 691 810 268	1 691 810 555
1 691 810 277	1 691 810 278	1 691 810 541
1 691 810 241	1 691 810 242	1 691 810 541
1 691 810 275	1 691 810 276	1 691 810 541

*Scope of delivery: Cables 15 m length (BD 5 and 6), cables 30 m length (BD 7 and 8)

BD	x	x	x	x
----	---	---	---	---

S	x	x
---	---	---

International scope of delivery with 1000 mm rollers*

BD	6	4	2	5
BD	6	4	2	5
BD	7	4	2	0
BD	7	4	2	4
BD	7	4	2	4
BD	7	4	2	5
BD	7	4	2	5
BD	8	4	2	0
BD	8	4	2	0
BD	8	4	2	4
BD	8	4	2	4
BD	8	4	2	4
BD	8	4	2	4
BD	8	4	2	5
BD	8	4	2	5
BD	8	4	2	5

S	1	0
S	2	0
S	2	0
S	2	0
S	1	0
S	0	5
S	1	0
S	2	0
S	2	0
S	0	5

--	--	--

Roller set left	Roller set right	Power box
1 691 810 269	1 691 810 270	1 691 810 555
1 691 810 279	1 691 810 280	1 691 810 541
1 691 880 508	1 691 880 509	1 691 880 535
1 691 880 518	1 691 880 519	1 691 880 539
1 691 880 522	1 691 880 523	1 691 880 539
1 691 880 520	1 691 880 521	1 691 880 535
1 691 880 524	1 691 880 525	1 691 880 535
1 691 810 526	1 691 810 527	1 691 810 555
1 691 810 510	1 691 810 511	1 691 810 541
1 691 810 560	1 691 810 561	1 691 810 545
1 691 810 522	1 691 810 523	1 691 810 549
1 691 810 570	1 691 810 571	1 691 810 545
1 691 810 512	1 691 810 513	1 691 810 545
1 691 810 572	1 691 810 573	1 691 810 541
1 691 810 524	1 691 810 525	1 691 810 541
1 691 810 556	1 691 810 557	1 691 810 541

German scope of delivery (incl. ASA livestream) with 1100 mm rollers*

BD	6	4	6	1
BD	6	4	6	6
BD	8	4	6	1
BD	8	4	6	6
BD	8	4	6	7

Roller set left	Roller set right	Power box
1 691 810 239	1 691 810 240	1 691 810 266
1 691 810 243	1 691 810 244	1 691 810 266
1 691 810 780	1 691 810 781	1 691 810 266
1 691 810 670	1 691 810 671	1 691 810 266
1 691 810 660	1 691 810 661	1 691 810 547

International scope of delivery with 1100 mm rollers*

BD	6	4	6	0
BD	6	4	6	0
BD	6	4	6	5
BD	6	4	6	5
BD	8	4	6	0
BD	8	4	6	4
BD	8	4	6	4
BD	8	4	6	5
BD	8	4	6	5

S	1	0
S	1	0
S	0	5
S	0	5

Roller set left	Roller set right	Power box
1 691 810 271	1 691 810 272	1 691 810 555
1 691 810 239	1 691 810 240	1 691 810 541
1 691 810 273	1 691 810 274	1 691 810 555
1 691 810 243	1 691 810 244	1 691 810 541
1 691 810 780	1 691 810 781	1 691 810 541
1 691 810 660	1 691 810 661	1 691 810 545
1 691 810 662	1 691 810 663	1 691 810 545
1 691 810 670	1 691 810 671	1 691 810 541
1 691 810 664	1 691 810 665	1 691 810 541

German scope of delivery (incl. ASA livestream) with 1300 mm rollers*

BD	8	4	4	6
BD	8	4	4	7

Roller set left	Roller set right	Power box
1 691 810 770	1 691 810 771	1 691 810 266
1 691 810 680	1 691 810 681	1 691 810 547

International scope of delivery with 1300 mm rollers*

BD	8	4	4	4
BD	8	4	4	5

Roller set left	Roller set right	Power box
1 691 810 680	1 691 810 681	1 691 810 545
1 691 810 770	1 691 810 771	1 691 810 541

*Scope of delivery: Cables 15m length (BD 5 and 6), cables 30m length (BD 7 and 8)

Beissbarth tire service for trucks



Big-size tire mounting MS 78 RC

- Bi-directional
- Two turning speeds
- MS 78: operation via wired remote control
- MS 78 RC: operation via r.f. remote control
- Extension of rim size up to 56"
(Special accessories)



Wheel balancer MT 788

- Usable for passenger-car wheels
- Static and dynamic balancing
- Automatic measurement cycle
- Pneumatic lift for effortless clamping of heavy wheels
- 2 programs for truck wheels
- Alloy programs for passenger cars

Beissbarth GmbH

Hanauer Str. 101
D-80993 Munich
Germany

Telephone: +49-(0)89-14901-0
Telefax: +49-(0)89-14901-246
sales@beissbarth.com